

EAST COAST RAILWAY

PCE CIRCULAR No. 04/2020, dated 29.12.2020

Sub: Protection of Trestles of Foot over bridges, implanted in between two tracks.

Foot over bridges (FOB) are important structure needs careful attention. Particularly the trestles of Foot over Bridges, in between two tracks are very much vulnerable, as they are likely to get entangled with the half opened doors of running Goods train. Hence while planning, structures in-between two tracks are to be avoided. However trestles of the existing FOBs in between the two tracks are required to be protected so as to avoid any entanglement and damage to the FOBs.

The sacrificial masts shall be provided at the same distance as that of the trestle face from the centre of the track or 2.4m, whichever is less. The sacrificial posts (2 nos.) made with rails encased in concrete foundation, should be 1.75m higher than Rail level, may be provided on both the sides. The first post should be at 3m and the second at 13m from the FOB trestle as per sketch (enclosed as annexure "A"). In few places 3 nos. of sacrificial masts have been provided, they may continue as such, however, the face of sacrificial masts should be in line with face of FOB trestles, i.e. equidistance from the centre of track in both the direction of traffic movement.

This circular supersedes item No.(E) of CE's Circular No.23 dt.14.10.2005.

Encl: Sketch as Annexure "A"

29/12/2020

(Natorram Singh Uikey)
Principal Chief Engineer
Date:29.12.2020

No.W4/374/CE's Circulars/Pt.I / 6468.

Copy to:

1. Secretary to GM for kind information of GM.
2. PS-I to AGM for kind information of AGM.
3. CAO/Con for information.
4. PCSO for information.
5. DRM/KUR, SBP & WAT for information.
6. CTE, CBE, CGE, CPDE, CE/BR, CE/RSW, CE/TM, CE/TP, CE/Works for information.
7. CPM-I & II/RVNL/BBS, CPM/RVNL/Raipur, CPM-I & II/VSKP for information.
8. CGM/IRCON/BBS for information.
9. GM/RITES/BBS for information.
10. CGM/PRCL/BBS for information.
11. Sr. DEN(Co)/KUR, SBP & WAT for information and necessary action.

SKETCH PLAN SHOWING ARRANGEMENT OF PROVISION OF SACRIFICIAL POST TO PREVENT DAMAGE TO FOB TRESTLE BETWEEN TWO TRACKS.

ANNEXURE-A

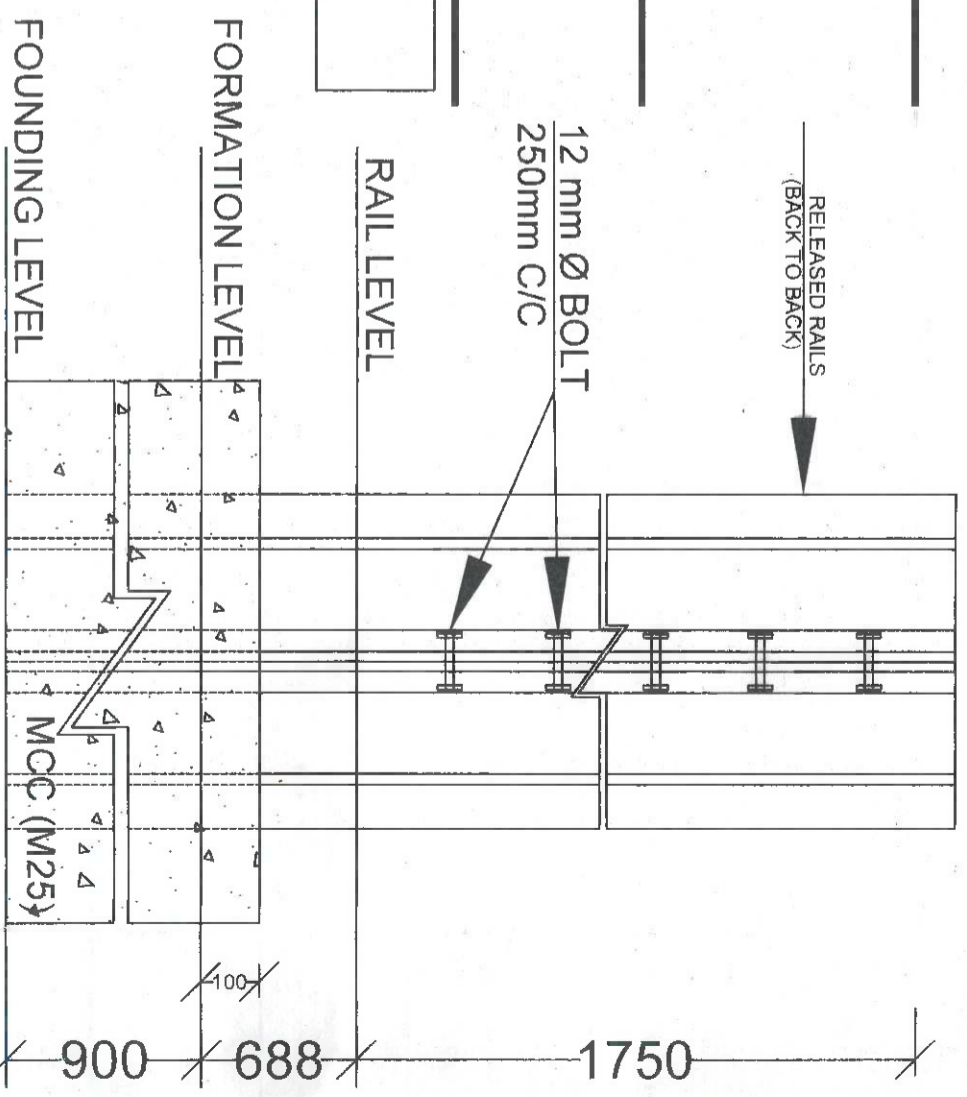
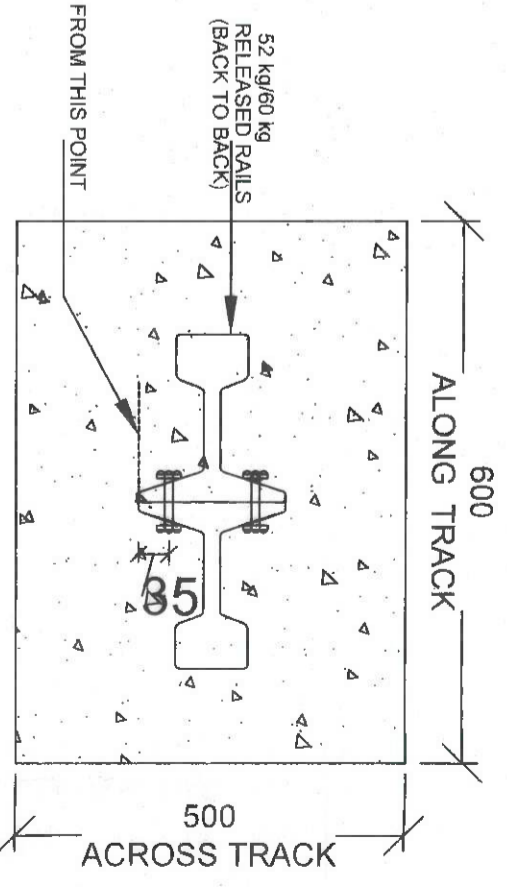
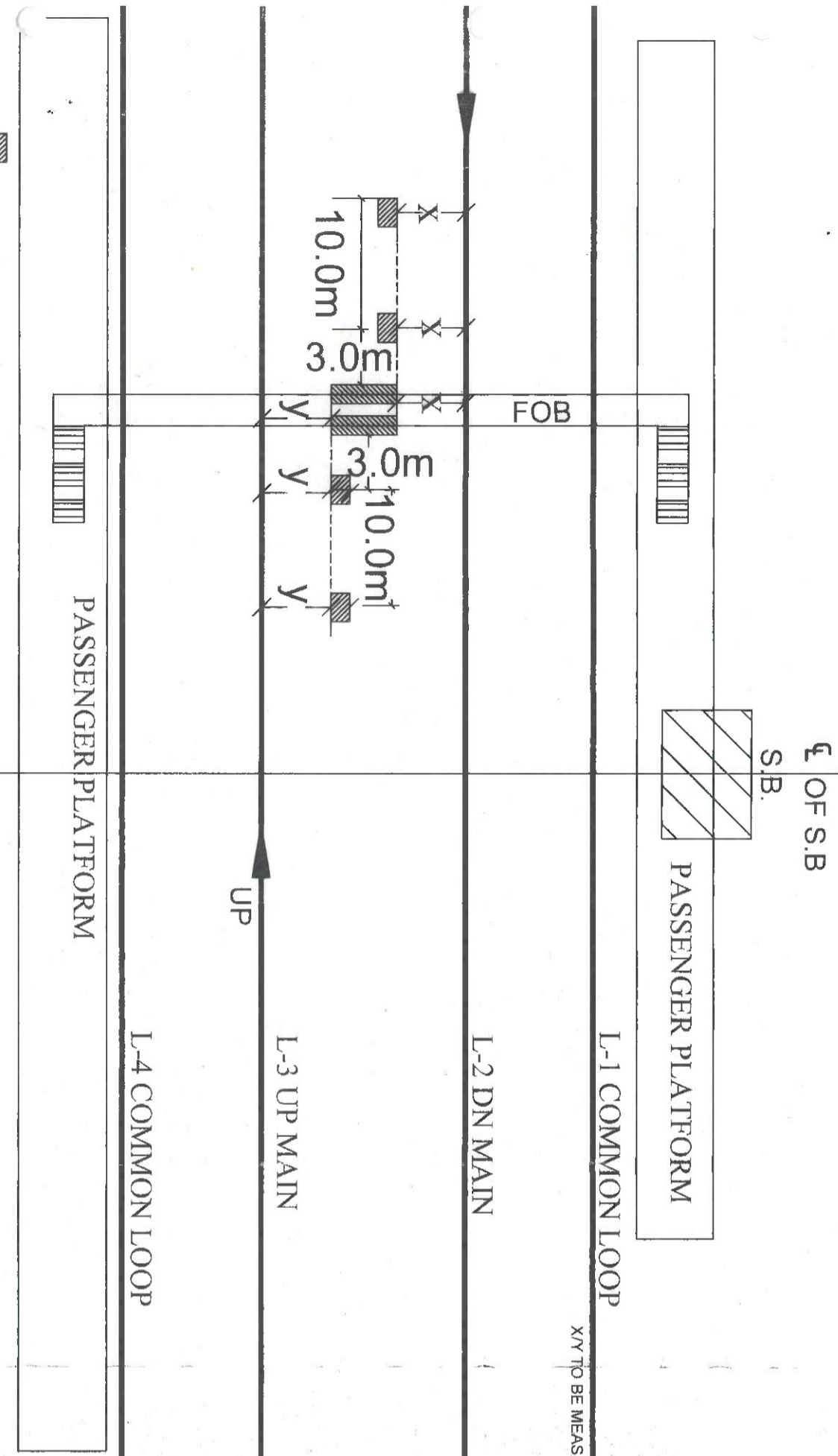

DETAILS OF SACRIFICIAL RAIL POST

- * IF THE MOVEMENT OF THE TRAFFIC IN ANY OF THE ADJACENT TRACK IS BIDIRECTIONAL, THE SACRIFICIAL POSTS SHOULD BE PROVIDED IN BOTH DIRECTION OF TRAFFIC IN THE SIMILAR MANNER.
- * X, Y : DISTANCE FROM FACING OF SACRIFICIAL POSTS & TRESTLE FROM CENTER LINE OF TRACK.
- * ALL DIMENTION ARE IN MM.
- * NOT TO SCALE.

Sripavathi
29-12-2020
DYCE/B&F

A. S. T. P.
29/12/20
CBE